

1 CRL50 CP2R

2 OVERLAP / Solapado / Sournois

3

LEVELLED/ Enrasado / Arasé

KEY
 C = LEFT SHEET / Hoja izquierda / Panneau gauche
 D = CENTRAL SHEET / Hoja central / Panneau centrale
 G = RIGHT SHEET / Hoja derecha / Panneau droite
 F = FIXED SHEET / Hoja fija / Panneau Fixe
 S = AMOUNT PANEL WILL EXTEND INTO OPENING TO ALLOW FOR HANDLE OR LOCK CLEARANCE / Medida que sobresale de la puerta para la cerradura o tirador
 LSC = LONG SIDE COVER / Tapeta lateral larga / Longue couvercle latéral
 SSC = SHORT SIDE COVER / Tapeta lateral corta / Court couvercle latéral

LEVELLED ASSEMBLY Instalación enrasada Mountage arasé		OVERLAP ASSEMBLY Instalación solapada Mountage Sournois	
$C = D$ $F = D + 10$ FG (Fixed glass width) = F-3mm $L = P - F$	$D = \frac{P+80}{3}$	$A = H - 88$ TC = L TL = P	$C = D + S$ $F = D + 10$ FG (Fixed glass width) = F-3mm $L = P - F$
$C = D$ $F = D + 3/8"$ FG (Fixed glass width) = F-1/8" $L = P - F$ Clear opening width = L	$D = \frac{P+3 1/8"}{3}$	$A = H - 3 7/16"$ TC = L TL = P	$C = D + S$ $F = D + 3/8"$ FG (Fixed glass width) = F-1/8" $L = P - F$ Clear opening width = L - S
mm	mm	mm	mm
inches	inches	inches	inches

4 Track assembly Montaje perfilera Assemblage profil

5 SPACER + BRAKES + ROLLER Gruesos + Frenos + Roldanas Epais + Frein + Roller

6

038060193

AVDB0000_01/23

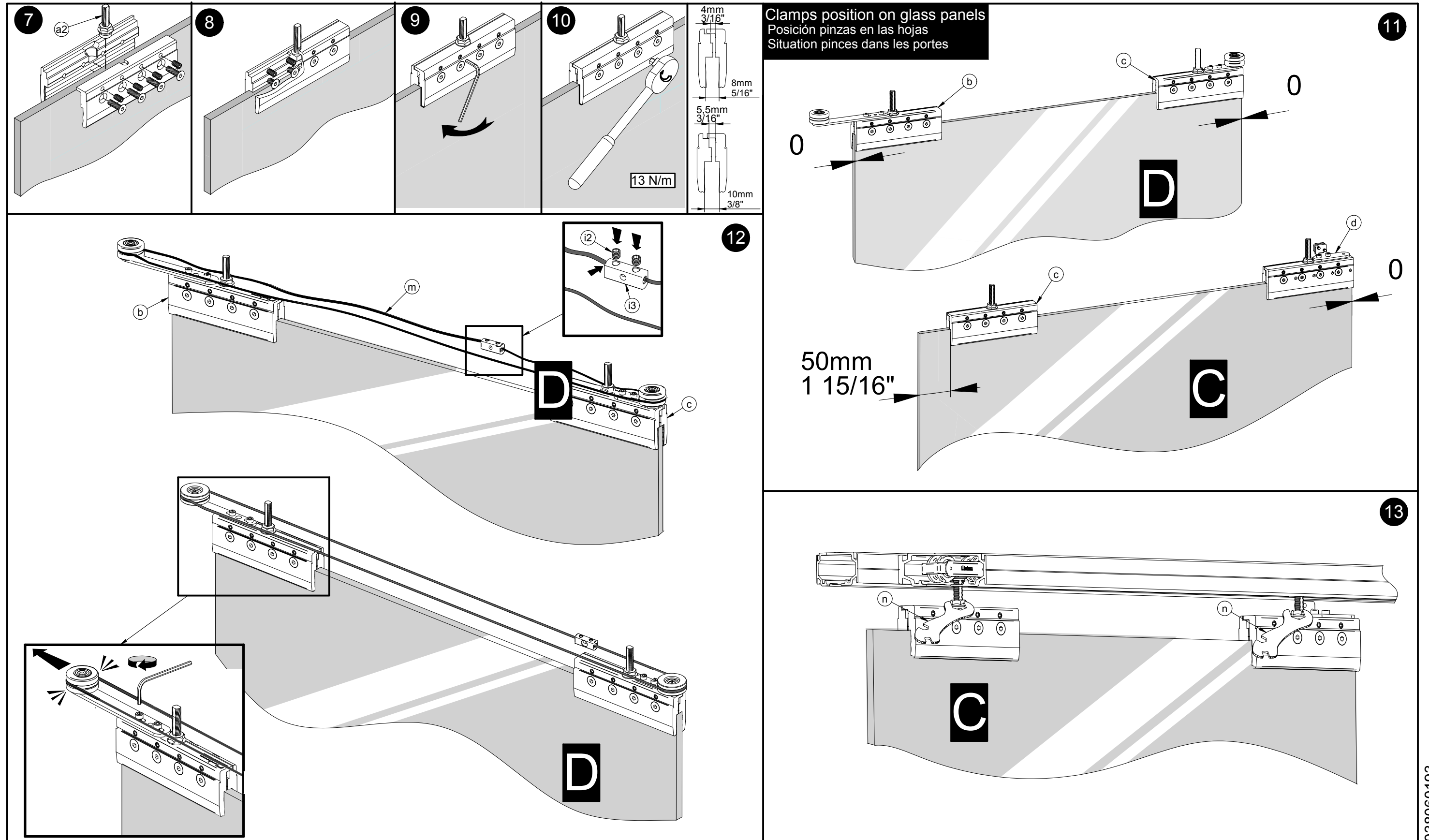

038060193

AVDB0000_01/23

Assembly with fixed glass
Montaje a vidrio fijo
Montage avec verre fixe

CRL501 CP2R

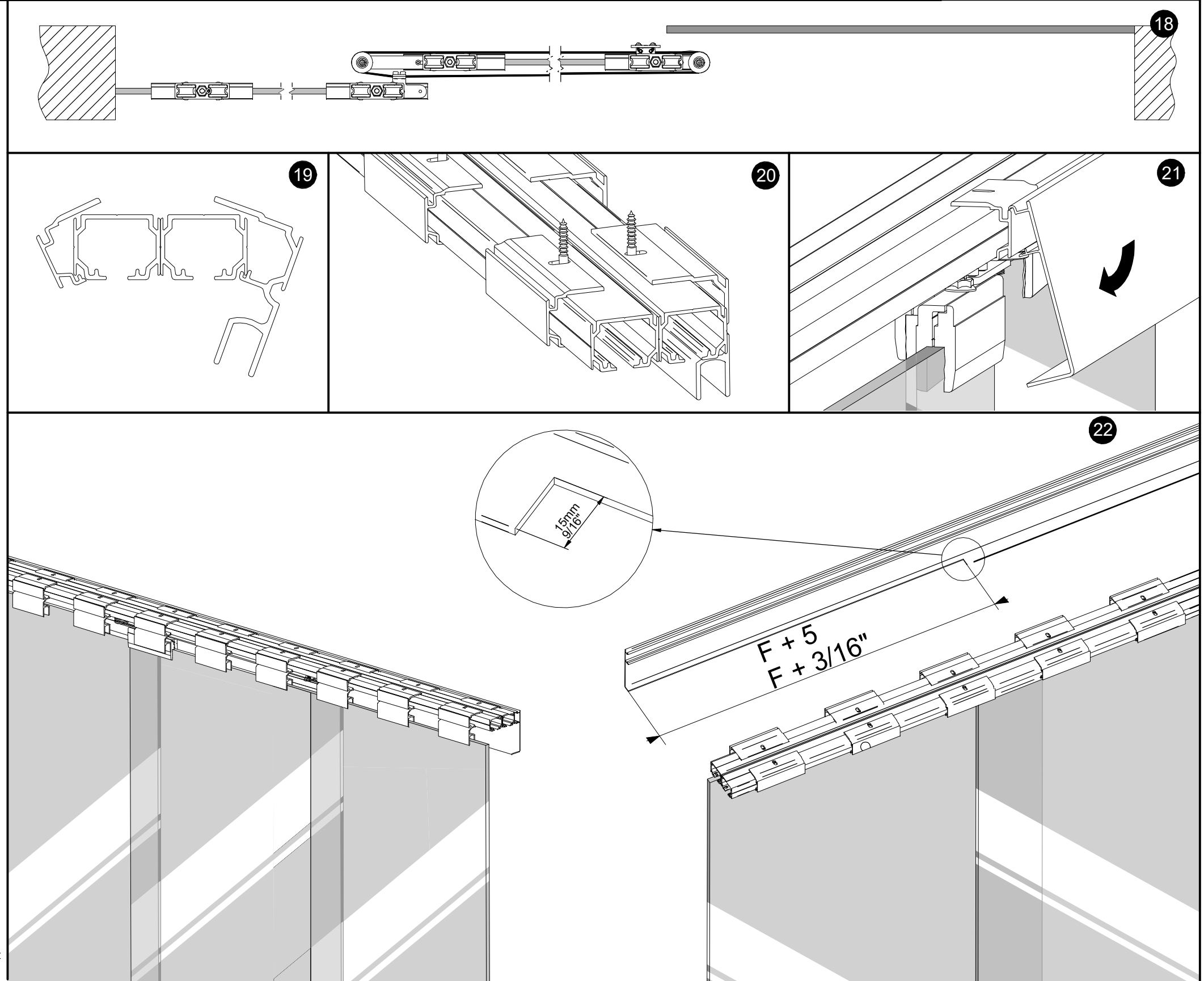
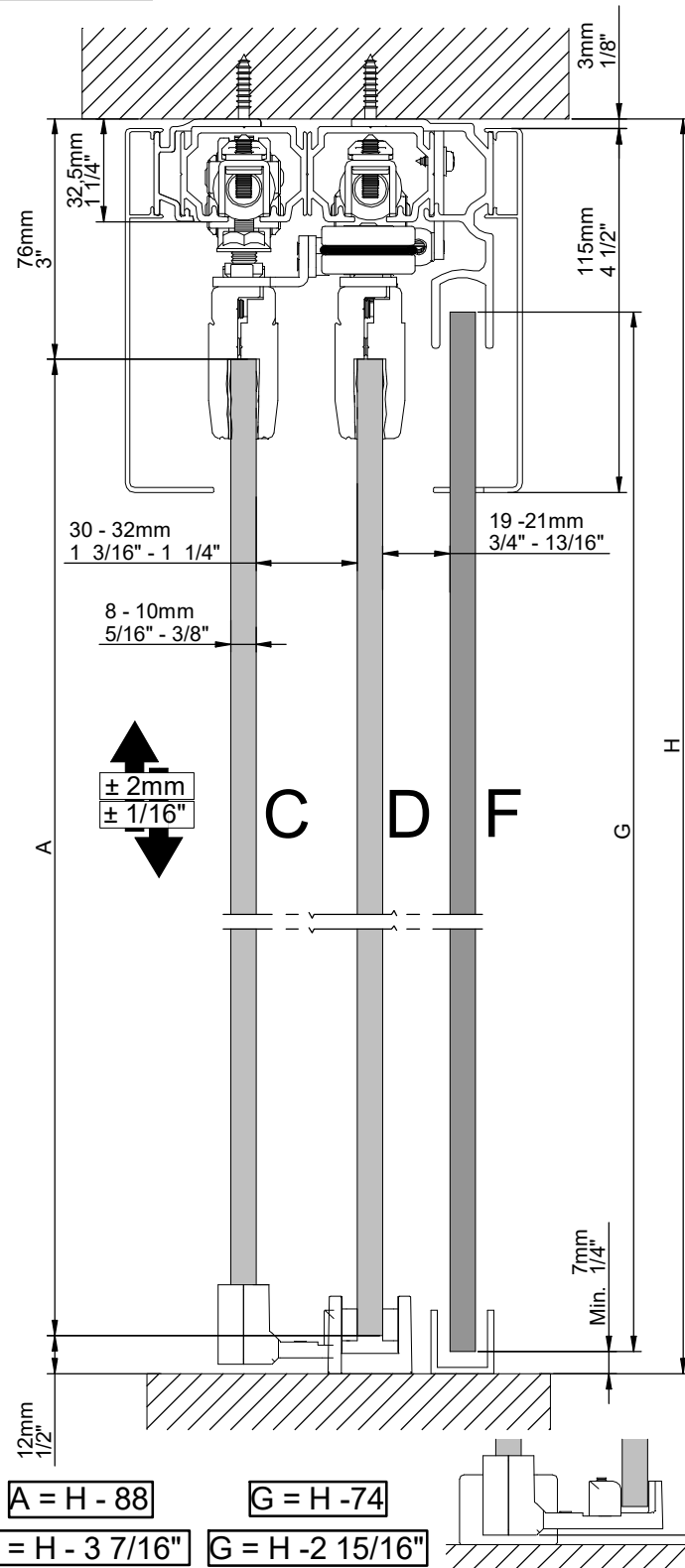

038060193

AVDB0000_01/23